

IV ADAPTORS JIC		
50.13	TUBE NUT	203
50.15	SLEEVE - IMPERIAL TUBE	203
50.17	JIC MALE NIPPLE	204
50.19	JIC MALE X BSPP MALE NIPPLE	205
50.25	JIC MALE X NPTF MALE NIPPLE	206
50.49	JIC FEMALE SWIVEL X BSPP MALE ADAPTOR	207
50.53	JIC BULKHEAD ADAPTOR	208
54.01	ELBOW 90° JIC MALE	208
54.13	ELBOW 90° JIC BULKHEAD ADAPTOR	209
54.09	ELBOW 90° JIC MALE X JIC FEMALE SWIVEL	209
54.11	ELBOW 90° JIC MALE X NPTF MALE	210
54.15	ELBOW 90° JIC MALE X TUBE WELD	211
54.51	TEE JIC MALE X MALE X MALE	211
54.55	TEE JIC MALE X FEMALE X MALE	212
54.59	TEE JIC MALE X MALE X FEMALE	212
50.21	JIC MALE X SAE O-RING BOSS	213
50.29	JIC MALE X BSPP FIXED FEMALE ADAPTOR	214
50.31	JIC MALE X JIC FIXED FEMALE ADAPTOR	215
50.39	JIC MALE WELD NIPPLE	216
50.45	JIC PLUG	216
50.46	JIC FEMALE SWIVEL X NPTF MALE ADAPTOR	217
50.43	JIC CAP	217
50.91	JIC FIXED FEMALE X BSPP GAUGE ADAPTOR	218
54.05	ELBOW 90° JIC MALE X BSPP ADJUSTABLE ADAPTOR	219
54.06	ELBOW 90° JIC MALE X SAE O-RING BOSS ADJUSTABLE ADAPTOR	220
54.61	TEE JIC MALE X BSPP ADJUSTABLE X JIC MALE	220

IV	ADAPTORS JIC	
54.63	TEE JIC MALE X JIC MALE X BSPP ADJUSTABLE ADAPTOR	221
54.65	TEE JIC MALE X SAE O-RING BOSS ADJUSTABLE X JIC MALE	221
54.67	TEE JIC MALE X JIC MALE X SAE O-RING BOSS ADJUSTABLE	222
54.81	TEE JIC MALE X NPTF MALE X JIC MALE	222
54.83	TEE JIC MALE X JIC MALE X NPTF MALE	223
54.90	CROSS EQUAL JIC MALE	223

5013

TUBE NUT

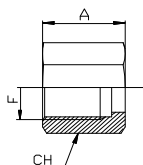

Artikelcode	F JIC 37°	Afmeting (mm)	
		A	CH
50130004	7/16	15,5	14
50130005	1/2	17	17
50130006	9/16	18,3	19
50130008	3/4	21,3	22
50130010	7/8	24,6	27
50130012	1*1/16	25,9	32
50130016	1*5/16	28,4	41
50130020	1*5/8	31	50
50130024	1*7/8	35,8	60

5015

SLEEVE - IMPERIAL TUBE

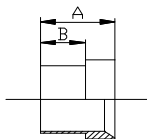

Artikelcode	F JIC 37°	Afmeting (mm)	
		A	B
50150004	7/16	10,4	6,8
50150005	1/2	11,2	7,1
50150006	9/16	12,7	8,4
50150008	3/4	14,2	8,6
50150010	7/8	16,8	10,7
50150012	1*1/16	17,3	10,7
50150016	1*5/16	19,8	12,7
50150020	1*5/8	23,1	15,2
50150024	1*7/8	28,4	19,8

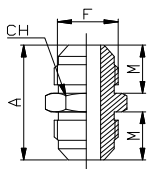
5017
JIC MALE NIPPLE

Artikelcode	F JIC 37°	Afmeting (mm)		
		A	M	CH
50170004	7/16	34,8	14	13
50170005	1/2	34,8	14	14
50170006	9/16	35,8	14,1	16
50170008	3/4	41,1	16,7	19
50170010	7/8	47,8	19,3	24
50170012	1*1/16	54,9	21,9	27
50170016	1*5/16	57,2	23,1	36
50170020	1*5/8	61,7	24,3	46
50170024	1*7/8	69,8	27,5	50

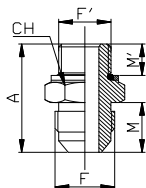
5019
JIC MALE X BSPP MALE NIPPLE

Artikelcode	F		Afmeting (mm)			
	JIC 37°	BSPP	A	M	M'	CH
50190402	7/16	1/8	28,7	14	6,3	16
50190404	7/16	1/4	32	14	9,5	19
50190406	7/16	3/8	33	14	9,5	22
50190408	7/16	1/2	38,6	14	13	30
50190504	1/2	1/4	32	14	9,5	19
50190506	1/2	3/8	33	14	9,5	22
50190604	9/16	1/4	32	14,1	9,5	19
50190606	9/16	3/8	33	14,1	9,5	22
50190608	9/16	1/2	38,6	14,1	13	30
50190804	3/4	1/4	35	16,7	9,5	19
50190806	3/4	3/8	36	16,7	9,5	22
50190808	3/4	1/2	41,4	16,7	13	30
50190812	3/4	3/4	42,4	16,7	13	36
50191006	7/8	3/8	39,1	19,3	9,5	24
50191008	7/8	1/2	43,9	19,3	13	30
50191012	7/8	3/4	43,9	19,3	13	36
50191206	1*1/16	3/8	42,4	21,9	9,5	30
50191208	1*1/16	1/2	46,7	21,9	13	30
50191212	1*1/16	3/4	47,5	21,9	13	36
50191216	1*1/16	1"	52,6	21,9	16	46
50191612	1*5/16	3/4	48,5	23,1	13	36
50191616	1*5/16	1"	53,6	23,1	16	46
50191620	1*5/16	1*1/4	55,1	23,1	16	50
50191624	1*5/16	1*1/2	55,8	23,1	16	60
50192016	1*5/8	1"	56	24,3	16	46
50192020	1*5/8	1*1/4	56,9	24,3	16	50
50192416	1*7/8	1"	59,8	27,5	16	50
50192420	1*7/8	1*1/4	60,4	27,5	16	50
50192424	1*7/8	1*1/2	61	27,5	16	60

5025

JIC MALE X NPTF MALE NIPPLE

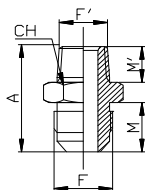

Artikelcode	F JIC 37°	F' NPTF	Afmeting (mm)			
			A	M	M'	CH
50250402	7/16	1/8	31	14	9,7	13
50250404	7/16	1/4	36	14	14,2	14
50250502	1/2	1/8	31	14	9,7	14
50250504	1/2	1/4	36,1	14	14,2	14
50250602	9/16	1/8	31,8	14,1	9,7	16
50250604	9/16	1/4	36,3	14,1	14,2	16
50250606	9/16	3/8	36,3	14,1	14,2	19
50250608	9/16	1/2	42,5	14,1	19	22
50250804	3/4	1/4	38,9	16,7	14,2	19
50250806	3/4	3/8	38,9	16,7	14,2	19
50250808	3/4	1/2	45,4	16,7	19	22
50250812	3/4	3/4	47	16,7	19	27
50251006	7/8	3/8	43,1	19,3	14,2	24
50251008	7/8	1/2	48	19,3	19	24
50251012	7/8	3/4	49,5	19,3	19	27
50251208	1*1/16	1/2	52,1	21,9	19	27
50251212	1*1/16	3/4	52,3	21,9	19	27
50251216	1*1/16	1"	57,1	21,9	23,9	36
50251608	1*5/16	1/2	53,5	23,1	19	36
50251612	1*5/16	3/4	53,5	23,1	19	36
50251616	1*5/16	1"	58,4	23,1	23,9	36
50252016	1*5/8	1"	61,5	24,3	23,9	46
50252020	1*5/8	1*1/4	62,2	24,3	24,6	46
50252420	1*7/8	1*1/4	68,1	27,5	24,6	50
50252424	1*7/8	1*1/2	68,1	27,5	25,4	50

5049

JIC FEMALE SWIVEL X BSPP MALE ADAPTOR

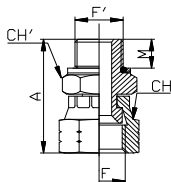

Artikelcode	F		Afmeting (mm)			
	JIC 37°	BSPP	A	M	CH	CH'
50490402	7/16	1/8	32,1	6,3	16	16
50490404	7/16	1/4	35,3	9,5	16	19
50490504	1/2	1/4	36,3	9,5	16	19
50490604	9/16	1/4	37,2	9,5	19	19
50490606	9/16	3/8	38,2	9,5	19	22
50490804	3/4	1/4	39,9	9,5	22	19
50490806	3/4	3/8	40,9	9,5	22	22
50490808	3/4	1/2	44,4	13	22	30
50491008	7/8	1/2	48,9	13	27	30
50491212	1"1/16	3/4	51,5	13	32	36
50491612	1"5/16	3/4	56,4	13	38	36
50491616	1"5/16	1"	59,4	16	38	46
50492020	1"5/8	1"1/4	64,6	16	50	50
50492424	1"7/8	1"1/2	70,2	16	60	60

5053

JIC BULKHEAD ADAPTOR

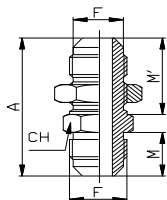

Artikelcode	F JIC 37°	Afmeting (mm)			
		A	M	M'	CH
50530004	7/16	52,6	14	31,3	17
50530005	1/2	52,6	14	31,3	19
50530006	9/16	55,4	14,1	33,3	22
50530008	3/4	62	16,7	37,4	24
50530010	7/8	69,6	19,3	40,9	30
50530012	1*1/16	78,5	21,9	45,2	36
50530016	1*5/16	79,8	23,1	46,5	41
50530020	1*5/8	84,1	24,3	46,5	50
50530024	1*7/8	89,4	27,5	46,8	55

5401

ELBOW 90° JIC MALE

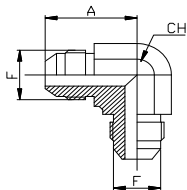

Artikelcode	F JIC 37°	Afmeting (mm)	
		A	CH
54010004	7/16	22,6	11
54010005	1/2	24,1	13
54010006	9/16	26,9	14
54010008	3/4	31,8	19
54010010	7/8	36,8	22
54010012	1*1/16	42,2	27
54010016	1*5/16	46	33
54010020	1*5/8	52,3	41
54010024	1*7/8	59,2	48

5413

ELBOW 90° JIC BULKHEAD ADAPTOR

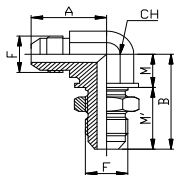

Artikelcode	F JIC 37°	Afmeting (mm)				
		A	B	M	M'	CH
54130004	7/16	24,6	40,4	12,1	28,3	11
54130005	1/2	26,2	41,1	12,8	28,3	13
54130006	9/16	27,7	46	15,9	30,1	14
54130008	3/4	34,5	53,6	18,6	35	19
54130010	7/8	39,6	60,7	22,2	38,5	22
54130012	1 1/16	45,2	67,8	25	42,8	27
54130016	1 5/16	49,3	71,1	28,3	42,8	33
54130020	1 5/8	55,1	79,2	35,1	44,1	41

5409

ELBOW 90° JIC MALE X JIC FEMALE SWIVEL

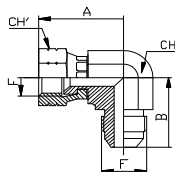

Artikelcode	F JIC 37°	Afmeting (mm)			
		A	B	CH	CH'
54090004	7/16	25,4	22,6	11	16
54090005	1/2	26,9	24,1	13	16
54090006	9/16	31,8	26,9	14	19
54090008	3/4	35,1	31,8	19	22
54090010	7/8	41,1	36,8	22	27
54090012	1 1/16	44,4	42,2	27	32
54090016	1 5/16	50,8	46	33	38
54090020	1 5/8	58,7	52,3	41	50
54090024	1 7/8	65,8	59,2	48	60

5411

ELBOW 90° JIC MALE X NPTF MALE

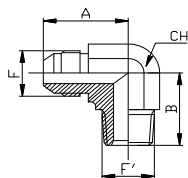

Artikelcode	F	F'	Afmeting (mm)		
	JIC 37°	NPTF	A	B	CH
54110402	7/16	1/8	22,6	19,8	11
54110404	7/16	1/4	26,9	27,7	14
54110502	1/2	1/8	24,1	19,8	13
54110504	1/2	1/4	26,9	27,7	14
54110602	9/16	1/8	26,9	22,8	14
54110604	9/16	1/4	26,9	27,7	14
54110606	9/16	3/8	29	31	19
54110608	9/16	1/2	31,2	37,3	22
54110804	3/4	1/4	31,8	31	19
54110806	3/4	3/8	31,8	31	19
54110808	3/4	1/2	33,7	37,3	22
54110812	3/4	3/4	36	40,4	27
54111006	7/8	3/8	36,8	33	22
54111008	7/8	1/2	36,8	37,3	22
54111012	7/8	3/4	38,9	40,4	27
54111208	1*1/16	1/2	42,2	40,4	27
54111212	1*1/16	3/4	42,2	40,4	27
54111612	1*5/16	3/4	46	45,2	33
54111616	1*5/16	1"	46	50	33
54112016	1*5/8	1"	52,3	59,6	41
54112020	1*5/8	1*1/4	52,3	60,5	41
54112424	1*7/8	1*1/2	59,2	67,1	48

5415

ELBOW 90° JIC MALE X TUBE WELD

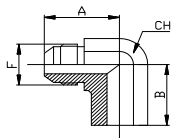

Artikelcode	F JIC 37°	Afmeting (mm)		
		A	B	CH
54150005	1/2	24,1	20	14
54150006	9/16	26,9	20	14
54150008	3/4	31,8	22	19
54150010	7/8	36,8	26	22

5451

TEE JIC MALE X MALE X MALE

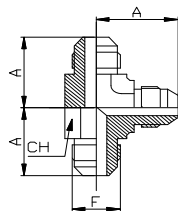

Artikelcode	F JIC 37°	Afmeting (mm)	
		A	CH
54510004	7/16	22,6	11
54510005	1/2	24,1	13
54510006	9/16	26,9	14
54510008	3/4	31,8	19
54510010	7/8	36,8	22
54510012	1*1/16	42,2	27
54510016	1*5/16	46	33
54510020	1*5/8	52,3	41
54510024	1*7/8	59,2	48

5455

TEE JIC MALE X FEMALE X MALE

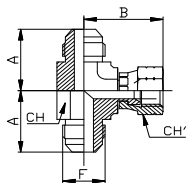

Artikelcode	F JIC 37°	Afmeting (mm)			
		A	B	CH	CH'
54550004	7/16	22,6	25,4	11	16
54550005	1/2	24,1	26,9	13	16
54550006	9/16	26,9	31,8	14	19
54550008	3/4	31,8	35,1	19	22
54550010	7/8	36,8	41,1	22	27
54550012	1*1/16	42,2	44,4	27	32
54550016	1*5/16	46	50,8	33	38
54550020	1*5/8	52,3	58,7	41	50
54550024	1*7/8	59,2	65,8	48	60

5459

TEE JIC MALE X MALE X FEMALE

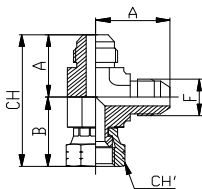

Artikelcode	F JIC 37°	Afmeting (mm)			
		A	B	CH	CH'
54590004	7/16	22,6	25,4	11	16
54590005	1/2	24,1	26,9	13	16
54590006	9/16	26,9	31,8	14	19
54590008	3/4	31,8	35,1	19	22
54590010	7/8	36,8	41,1	22	27
54590012	1*1/16	42,2	44,4	27	32
54590016	1*5/16	46	50,8	33	38
54590020	1*5/8	52,3	58,7	41	50
54590024	1*7/8	59,2	65,8	48	60

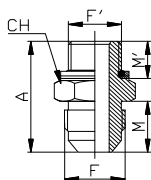
5021
JIC MALE X SAE O-RING BOSS

Artikelcode	F		Afmeting (mm)			
	JIC 37°	F'	A	M	M'	CH
50210404	7/16	7/16	31,4	14	9,1	14
50210405	7/16	1/2	31,2	14	9,1	16
50210406	7/16	9/16	33	14	9,9	17
50210505	1/2	1/2	31,2	14	9,1	16
50210606	9/16	9/16	32,9	14,1	9,9	17
50210608	9/16	3/4	35,1	14,1	11,1	22
50210808	3/4	3/4	37,8	16,7	11,1	22
50210810	3/4	7/8	40,6	16,7	12,7	27
50210812	3/4	1*1/16	44,7	16,7	15,1	32
50211008	7/8	3/4	40,6	19,3	11,1	24
50211010	7/8	7/8	43,2	19,3	12,7	27
50211012	7/8	1*1/16	47,5	19,3	15,1	32
50211208	1*1/16	3/4	45,2	21,9	11,1	27
50211210	1*1/16	7/8	46,7	21,9	12,7	27
50211212	1*1/16	1*1/16	50	21,9	15,1	32
50211216	1*1/16	1*5/16	50,6	21,9	15,1	38
50211612	1*5/16	1*1/16	51,1	23,1	15,1	36
50211616	1*5/16	1*5/16	51,8	23,1	15,1	38
50211620	1*5/16	1*5/8	53,8	23,1	15,1	50
50212016	1*5/8	1*5/16	55	24,3	15,1	50
50212020	1*5/8	1*5/8	55,1	24,3	15,1	50
50212024	1*5/8	1*7/8	57	24,3	15,1	55
50212424	1*7/8	1*7/8	60,2	27,5	15,1	55

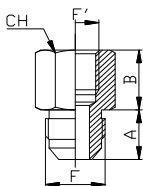
5029
JIC MALE X BSPP FIXED FEMALE ADAPTOR

Artikelcode	F	F'	Afmeting (mm)		
	JIC 37°	BSPP	A	B	CH
50290402	7/16	1/8	14	16,2	14
50290404	7/16	1/4	14	21,3	19
50290502	1/2	1/8	14	15,7	14
50290504	1/2	1/4	14	21,5	19
50290604	9/16	1/4	14,1	21,5	19
50290606	9/16	3/8	14,1	23	22
50290806	3/4	3/8	16,7	22,9	22
50290808	3/4	1/2	16,7	28,7	30
50291008	7/8	1/2	19,3	28,7	30
50291208	1*1/16	1/2	21,9	28,7	30
50291212	1*1/16	3/4	21,9	30,4	36
50291616	1*5/16	1"	23,1	36,6	46
50292020	1*5/8	1*1/4	24,3	35	50
50292424	1*7/8	1*1/2	27,5	35	60

5031

JIC MALE X JIC FIXED FEMALE ADAPTOR

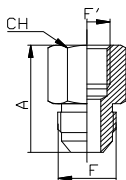

Artikelcode	F	F'	Afmeting (mm)	
	JIC 37°	JIC 37°	A	CH
50310504	1/2	7/16	28	19
50310604	9/16	7/16	24,6	
50310605	9/16	1/2	29	19
50310804	3/4	7/16	25,4	
50310805	3/4	1/2	25,4	
50310806	3/4	9/16	25,4	
50311004	7/8	7/16	26,2	
50311006	7/8	9/16	26,2	
50311008	7/8	3/4	36,5	27
50311204	1*1/16	7/16	27,7	
50311206	1*1/16	9/16	27,7	
50311208	1*1/16	3/4	30,2	
50311210	1*1/16	7/8	42,1	32
50311612	1*5/16	1*1/16	37,3	
50312012	1*5/8	1*1/16	38,8	
50312412	1*5/8	1*1/16	38,8	
50312016	1*5/8	1*5/16	40,3	
50312420	1*7/8	1*5/8	42,9	

5039

JIC MALE WELD NIPPLE

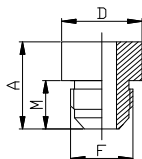

Artikelcode	F	Afmeting (mm)		
		A	M	D
50390004	JIC 37° 7/16	23	14	12
50390005	1/2	24	14	12
50390006	9/16	24	14,1	14
50390008	3/4	24	16,7	20
50390010	7/8	30	19,3	22
50390012	1*1/16	34	21,9	28
50390016	1*5/16	37	23,1	34

5045

JIC PLUG

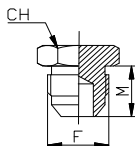

Artikelcode	F	Afmeting (mm)	
		M	CH
50450004	JIC 37° 7/16	20,3	13
50450005	1/2	20,3	14
50450006	9/16	21,3	16
50450008	3/4	23,9	19
50450010	7/8	27,9	24
50450012	1*1/16	32,5	27
50450016	1*5/16	33,8	36
50450020	1*5/8	36,8	46
50450024	1*7/8	41,9	50

5046

JIC FEMALE SWIVEL X NPTF MALE ADAPTOR

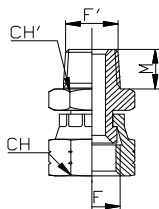

Artikelcode	F	F'	Afmeting (mm)		
	JIC 37°	NPTF	M	CH	CH'
50460402	7/16	1/8			
50460404	7/16	1/4	14,2	16	14
50460504	1/2	1/4	14,2	16	14
50460604	9/16	1/4	14,2	19	14
50460606	9/16	3/8	14,2	19	19
50460806	3/4	3/8	14,2	22	19
50460808	3/4	1/2	14,2	22	22
50461006	7/8	3/8	14,2	27	22
50461008	7/8	1/2	19	27	22
50461208	1"1/16	1/2	19	32	27
50461212	1"1/16	3/4	19	32	27
50461612	1"5/16	3/4	19	38	32
50461616	1"5/16	1"	23,9	38	36
50462020	1"5/8	1"1/4	24,6	50	46

5043

JIC CAP

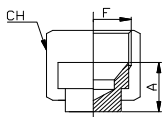

Artikelcode	F	Afmeting (mm)	
	JIC 37°	A	CH
50430004	7/16	9	14
50430005	1/2	10,5	17
50430006	9/16	10,5	19
50430008	3/4	13	22
50430010	7/8	14	27
50430012	1"1/16	14	32
50430016	1"5/16	17	41
50430016	1"5/8	19	50
50430024	1"7/8	21	60

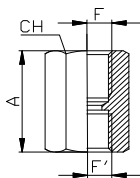
5091
JIC FIXED FEMALE X BSPP GAUGE ADAPTOR

Artikelcode	F JIC 37°	F' BSPP	Afmeting (mm)	
			A	CH
50910504	1/2	1/4	29	19
50910604	9/16	1/4	29	19
50910804	3/4	1/4	32	22
50911004	7/8	1/4	32	27

5405

ELBOW 90° JIC MALE X BSPP ADJUSTABLE ADAPTOR

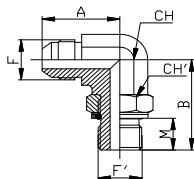

Artikelcode	F JIC 37°	F' BSPP	Afmeting (mm)				
			A	B	M	CH	CH'
54050402	7/16	1/8	22,6	26	6,3	11	14
54050404	7/16	1/4	26,9	32	9,5	14	19
54050504	1/2	1/4	26,9	33	9,5	14	19
54050604	9/16	1/4	26,9	32	9,5	14	19
54050606	9/16	3/8	29	37	9,5	19	22
54050804	3/4	1/4	31,8	37	9,5	19	19
54050806	3/4	3/8	31,8	37	9,5	19	22
54050808	3/4	1/2	33,7	43	13	22	27
54051006	7/8	3/8	36,8	43	9,5	22	22
54051008	7/8	1/2	36,8	43	13	22	27
54051208	1*1/16	1/2	42,2	49,5	13	27	27
54051212	1*1/16	3/4	42,2	49,5	13	27	36
54051612	1*5/16	3/4	46	52	13	33	36
54051616	1*5/16	1"	46	52	16	33	41
54051620	1*5/16	1*1/4	50	57	13,8	41	50
54052016	1*5/8	1"	52,3	57	16	41	41
54052020	1*5/8	1*1/4	52,3	57	16	41	50
54052424	1*7/8	1*1/2	59,2	60,5	16	48	55

5406

ELBOW 90° JIC MALE X SAE O-RING BOSS ADJUSTABLE ADAPTOR

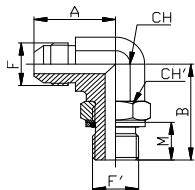

Artikelcode	F JIC 37°	F' UNF	Afmeting (mm)				
			A	B	M	CH	CH'
54060404	7/16	7/16	22,6	26,2	9	11	14
54060405	7/16	1/2	24,1	27,7	9	13	16
54060505	1/2	1/2	24,1	27,7	9	13	16
54060606	9/16	9/16	26,9	31,8	10	14	17
54060808	3/4	3/4	31,8	36,8	11	19	22
54060810	3/4	7/8	34	43,2	11	22	27
54061010	7/8	7/8	36,8	43,2	12,5	22	27
54061210	1*1/16	7/8	42,2	45,2	15	27	27
54061212	1*1/16	1*1/16	42,2	49,3	15	27	32
54061612	1*5/16	1*1/16	46	52,1	15	33	32
54061616	1*5/16	1*5/16	46	52,1	15	33	38
54062020	1*5/8	1*5/8	52,3	57,2	15	41	50
54062424	1*7/8	1*7/8	59,2	60,7	15	48	55

5461

TEE JIC MALE X BSPP ADJUSTABLE X JIC MALE

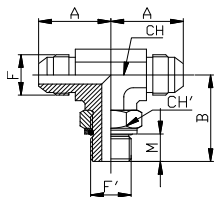

Artikelcode	F JIC 37°	F' BSPP	Afmeting (mm)				
			A	B	M	CH	CH'
54610402	7/16	1/8	22,6	26	6,3	11	14
54610502	1/2	1/8	24,1	26	6,3	13	14
54610604	9/16	1/4	26,9	32	9,5	14	19
54610606	9/16	3/8	29	37	9,5	19	22
54610806	3/4	3/8	31,8	37	9,5	19	22
54611008	7/8	1/2	36,8	43	13	22	27
54611012	7/8	3/4	42	50	12	27	36
54611208	1*1/16	1/2	42,2	49,5	13	27	27
54611212	1*1/16	3/4	42,2	49,5	13	27	36
54611616	1*5/16	1*	46	52	16	33	41

5463

TEE JIC MALE X JIC MALE X BSPP ADJUSTABLE ADAPTOR

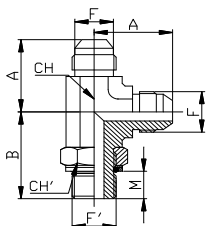

Artikelcode	F	F'	Afmeting (mm)				
	JIC 37°	BSPP	A	B	M	CH	CH'
54630402	7/16	1/8	22,6	26	6,3	11	14
54630502	1/2	1/8	24,1	26	6,3	13	14
54630604	9/16	1/4	26,9	32	9,5	14	19
54630606	9/16	3/8	26,9	37	9,5	19	22
54630806	3/4	3/8	31,8	37	9,5	19	22
54631008	7/8	1/2	36,8	43	13	22	27
54631208	1"1/16	1/2	42,2	49,5	13	27	27
54631212	1"1/16	3/4	42,2	49,5	13	27	36
54631616	1"5/16	1"	46	52	16	33	41

5465

TEE JIC MALE X SAE O-RING BOSS ADJUSTABLE X JIC MALE

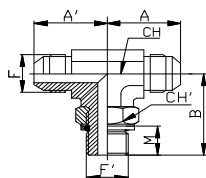

Artikelcode	F	F'	Afmeting (mm)				
	JIC 37°	UNF	A	B	M	CH	CH'
54650404	7/16	7/16	22,6	26,2	9	11	14
54650505	1/2	1/2	24,1	27,7	9	13	16
54650606	9/16	9/16	26,9	31,8	10	14	17
54650808	3/4	3/4	31,8	36,8	11	19	22
54651010	7/8	7/8	36,8	43,2	12,5	22	27
54651212	1"1/16	1"1/16	42,2	49,3	15	27	32
54651616	1"5/16	1"5/16	46	52,1	15	33	38

5467

TEE JIC MALE X JIC MALE X SAE O-RING BOSS ADJUSTABLE

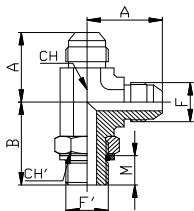

Artikelcode	F JIC 37°	F' UNF	Afmeting (mm)				
			A	B	M	CH	CH'
54670404	7/16	7/16	22,6	26,2	9	11	14
54670505	1/2	1/2	24,1	27,7	9	13	16
54670606	9/16	9/16	26,9	31,8	10	14	17
54670808	3/4	3/4	31,8	36,8	11	19	22
54671010	7/8	7/8	36,8	43,2	12,5	22	27
54671212	1"1/16	1"1/16	42,2	49,3	15	27	32
54671616	1"5/16	1"5/16	46	52,1	15	33	38

5481

TEE JIC MALE X NPTF MALE X JIC MALE

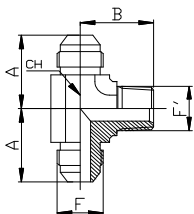

Artikelcode	F JIC 37°	F' NPTF	Afmeting (mm)		
			A	B	CH
54810402	7/16	1/8	22,6	19,8	11
54810404	7/16	1/4	26	27,7	14
54810502	1/2	1/8	24,1	19,8	13
54810604	9/16	1/4	26,9	27,7	14
54810606	9/16	3/8	28,1	31	19
54810806	3/4	3/8	31,8	31	19
54810808	3/4	1/2	33	37,3	22
54811008	7/8	1/2	36,8	37,3	22
54811212	1"1/16	3/4	42,2	40,4	27
54811616	1"5/16	1"	46	50	33

5483

TEE JIC MALE X JIC MALE X NPTF MALE

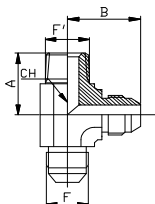

Artikelcode	F	F'	Afmeting (mm)		
	JIC 37°	NPTF	A	B	CH
54830402	7/16	1/8	19,8	22,6	11
54830404	7/16	1/4	27,7	26	14
54830502	1/2	1/8	19,8	24,1	13
54830604	9/16	1/4	27,7	26,9	14
54830606	9/16	3/8	31	28,1	19
54830806	3/4	3/8	31	31,8	19
54830808	3/4	1/2	37,3	33	22
54831008	7/8	1/2	37,3	36,8	22
54831212	1"1/16	3/4	40,4	42,2	27
54831616	1"5/16	1"	50	46	33

5490

CROSS EQUAL JIC MALE

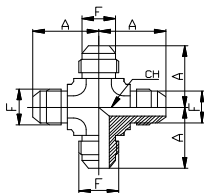

Artikelcode	F	Afmeting (mm)	
	JIC 37°	A	CH
54900004	7/16	22,6	11
54900005	1/2	24,1	13
54900006	9/16	26,9	14
54900008	3/4	31,8	19
54900010	7/8	36,8	22
54900012	1"1/16	42,2	27
54900016	1"5/16	46	33
54900020	1"5/8	52,3	41
54900024	1"7/8	59,2	48

